



# 507HT



## »» Features

- Low profile 15.7 mm PCB Power Relay.
- High rating 17A 277VAC.
- Design for high temperature 105°C application.
- Available for 1C/O contact configurations ; flux-tight & sealed versions.
- HighCTI 250 materialm & new Glowwire test test approved (E-Version)
- Comply with RoHS-Directive 2011/65/EU:

## »» Type List

### ◆ Standard type

Terminal style	Contact form	UL Insulation system approval	Designation (provided with)	
			Flux tight	Sealed type washable
PCB terminal	1A (SPNO)	F	507HT-1AH-F-C	507HT-1AH-F-S
	1C (SPDT)	F	507HT-1CH-F-C	507HT-1CH-F-S

### ◆ High sensitivity type

PCB terminal	1A (SPNO)	F	507HTN-1AH-F-C	507HTN-1AH-F-S
	1C (SPDT)	F	507HTN-1CH-F-C	507HTN-1CH-F-S

## »» Ordering Information

507   HT      - 1C   H - F - C   E   XXVXC  
 1        2        3        4        5        6        7        8        9

- |           |                                       |           |   |
|-----------|---------------------------------------|-----------|---|
| 1. 507    | -- Basic series designation           | 6 . F     | -- Class F  |
| 2 . HT    | -- High power & high temperature type | 7 . C     | -- Flux tight   |
| 3 . Blank | -- Standard type (0.53W)              | S         | -- Seales type washable   |
| N         | -- High sensitive type (0.4W)         | 8 . Blank | -- Standard type  |
| 4 . 1A    | -- Single pole normally open          | E         | -- CTI 250V   |
| 1C        | -- Single pole double throw           | 9 . XXVXC | -- Coil voltage (please refer to the coil rating data for the availability) |
| 5 . H     | -- Contact material AgSnO             |           |   |

## »» Contact Rating

Rated load (resistive)	NO: 16A 240VAC, 100K ops. 16A 240VAC 105°C, 100K ops., frequency 360 ops./hr (B10 value) 10A 240VAC 105°C, 300K ops., frequency 360 ops./hr (B10 value)
Max. switching current	17A
Max. switching voltage	277VAC
Max. switching capacity	4080VA

### »» Coil Rating (DC)

#### ◆ Standard type

Rated voltage (V)	Rated current ±10% at 23°C (mA)	Coil resistance ±10% at 23°C (Ω)	Max. continuous voltage at 105°C	Pick up voltage(Max.) at 23°C	Drop out voltage(Min.) at 23°C	Power consumption at rated voltage
3	176	17	150 % of rated voltage	75 % of rated voltage	10 % of rated voltage	approx. 0.53W
5	106	47				
6	88	68				
9	59	153				
12	44	272				
15	35	425				
18	29	611				
24	22	1,087				
36	15	2,445				
48	11	4,347				

#### ◆ High sensitivity type (N)

Rated voltage (V)	Rated current ±10% at 23°C (mA)	Coil resistance ±10% at 23°C (Ω)	Max. continuous voltage at 105°C	Pick up voltage(Max.) at 23°C	Drop out voltage(Min.) at 23°C	Power consumption at rated voltage
3	133	22.5	150 % of rated voltage	70 % of rated voltage	10 % of rated voltage	approx. 0.40W
5	80	62				
6	67	90				
9	44	203				
12	33	360				
18	23	771				
24	17	1,440				
36	11	3,240				
48	9	5,520				
60	6.7	9,000±15%				
110	3.7	30,000±15%				

### »» Specification

Contact material	AgSnO alloy	
Contact resistance <sup>(1)</sup>	100mΩ Max. (1A/6VDC by 4 pipes mΩ meter)	
Operate time <sup>(1)</sup>	20ms Max.	
Release time <sup>(1)</sup>	10ms Max.	
Insulation resistance <sup>(1)</sup>	1000MΩ Min. (DC 500V)	
Dielectric strength <sup>(1)</sup>	Between open contact	: AC 1000V, 50/60Hz 1 min.
	Between contact and coil	: AC 5000V, 50/60Hz 1 min.
Surge voltage withstand <sup>(1)</sup>	Between contact and coil : 10KV (1.2X50)μS	
Vibration resistance	Operating extremes	10~55Hz , amplitude 1.5 mm
	Damage limits	10~55Hz , amplitude 1.5 mm
Shock resistance	Operating extremes	10G
	Damage limits	100G
Life expectancy	Mechanical	30,000,000 operations (frequency 36,000 operations /hr)
Operating ambient temperature	-40 ~+105°C (no freezing)	
Weight	Approx. 10 g	

Note: (1) initial value



# 507HT

## »» Safety Approval

Certified	UL / CUL	VDE
File No.	E88991	40006746

## »» Safety Approval Rating

UL/CUL	VDE
17A 277VAC	17A 250VAC T105

## »» Outline Dimensions

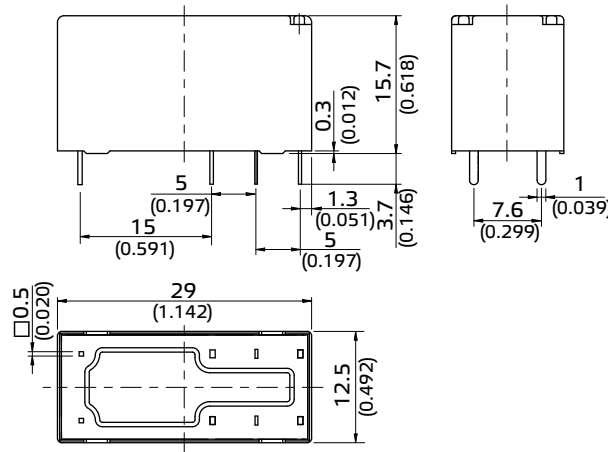

## »» Wiring Diagram

BOTTOM VIEW

1C

1A

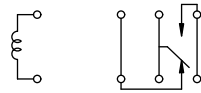

## »» PC Board Layout

BOTTOM VIEW

1C

1A

